

# MG100B User Manual

## (Connecting the Laptop to the Dock)

Please carefully follow the operational steps to familiarize yourself with the use of this product.

### Step 1, Connecting the Laptop to the Dock:

Connect the dock's HOST port using the included USB-C to USB-C cable to the laptop's USB-C port (The USB-C port must be a full-feature port or USB3.0 or higher).

(After connection, all ports of the dock and both the wireless chargers on the top and bottom can start working normally. Note: Only one of the TF/SD card slots can work at a time; the one inserted first will be active.)



### Step 2, Powering the Laptop:

Power Method 1:

Use the original laptop charger to connect to the laptop's charging port for power supply.



Power Method 2:

Use a PD(65W or above) charger to connect to the dock's PD port for power supply.



# MG100B User Manual

## (Connecting the Tablet to the Dock)

Please carefully follow the operational steps to familiarize yourself with the use of this product.

### Step 1, How to use it as a magnetic tablet stand?

Peel off the white film on the provided magnet ring, stick the magnet ring to the center of the tablet's back, attach the tablet to the magnetic stand.

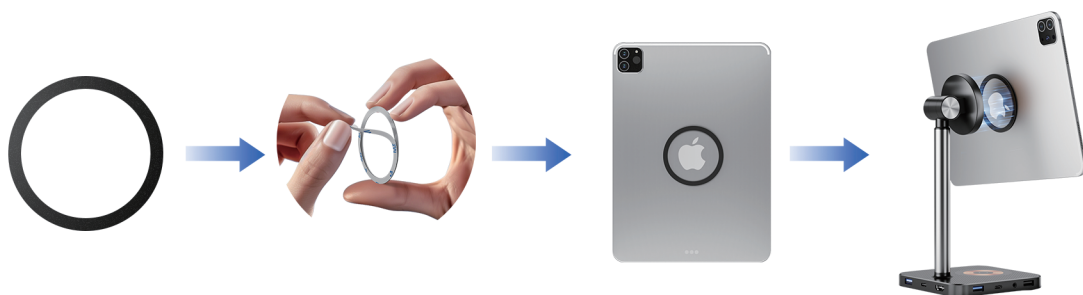

### Step 2, Connecting the Tablet to the Dock:

Connect the dock's HOST port using the included USB-C to USB-C cable to the tablet's USB-C port (The USB-C port must be a full-feature port or USB3.0 or higher).

(After connection, all ports of the dock and both the wireless chargers on the top and bottom can start working normally. Note: Only one of the TF/SD card slots can work at a time; the one inserted first will be active.)



### Step 3, Powering the Tablet:

Use a PD(45W or above) charger to connect to the dock's PD port for power supply.

